

TCHR-60-110

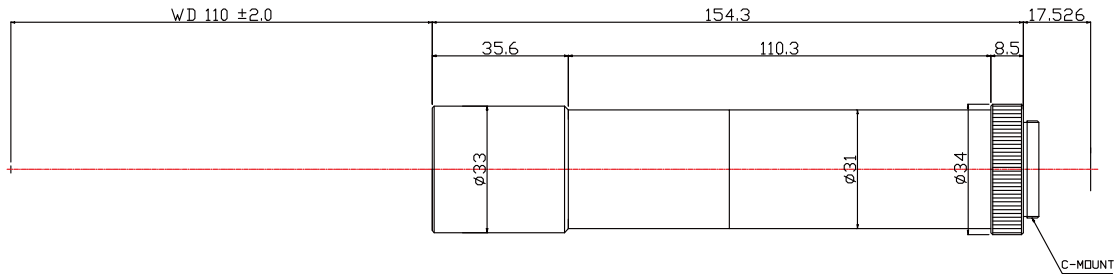

The Object Side Telecentric Lens TCHR-60-110 is suitable for sensors with an image format of 2/3 inch.

Technical Data

| | |
|---------------------------|-------------------------|
| Magnification | 6 X |
| Mount Type | C-Mount |
| Aperture (F) | 33.3 |
| Working Distance (WD) | 110 |
| Depth of Field (DOF) | 74 µm |
| Resolution (Object Side) | 3.72 µm |
| Numerical Aperture (NA) | 0.09 |
| Image Format (max.) | 2/3 inch |
| Field of View (FOV) | 1.47mm x 1.1mm@2/3" CCD |
| Telecentric Type | Object Side |
| Telecentricity | 0.05 ° |
| Optical Distortion (max.) | 0.03 % |
| Special Feature | High Res |

