

TCHR-30-110C

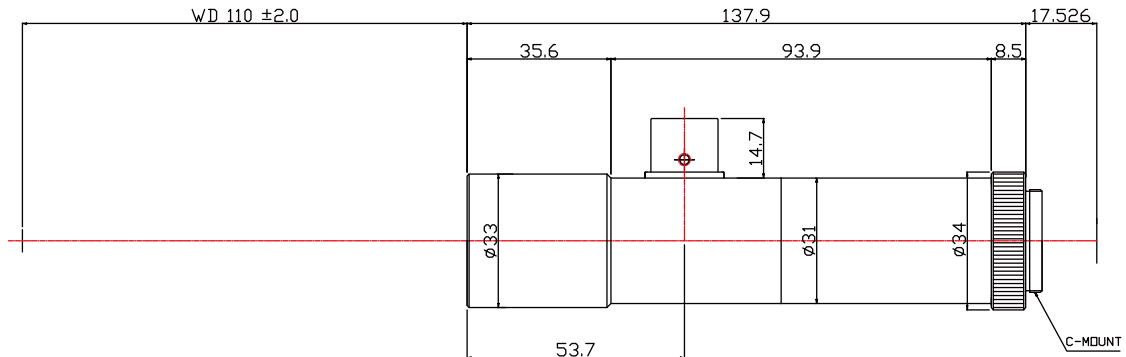

The Object Side Telecentric Lens TCHR-30-110C is suitable for sensors with an image format of 2/3 inch.

Technical Data

Magnification	3 X
Mount Type	C-Mount
Aperture (F)	16.6
Working Distance (WD)	110
Depth of Field (DOF)	148 µm
Resolution (Object Side)	3.7 µm
Numerical Aperture (NA)	0.09
Image Format (max.)	2/3 inch
Field of View (FOV)	2.93mm x 2.2mm @2/3" CCD
Telecentric Type	Object Side
Telecentricity	0.02 °
Optical Distortion (max.)	0.11 %
Special Feature	High Res

