

TC5M-07-110I

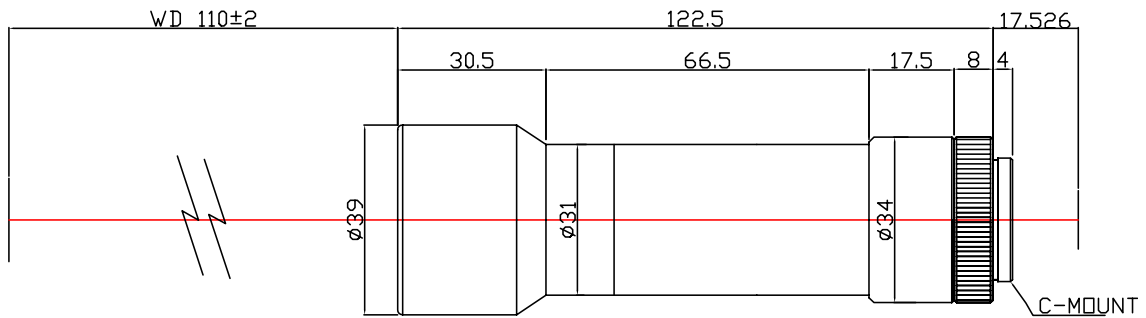

The Object Side Telecentric Lens TC5M-07-110I is suitable for sensors up to 5 megapixel and with an image format of 2/3 inch.

Technical Data

Magnification	0.7 X
Mount Type	C-Mount
Aperture (F)	5.38
Working Distance (WD)	110
Depth of Field (DOF)	439 µm
Resolution (Object Side)	5.15 µm
Numerical Aperture (NA)	0.0651
Image Format (max.)	2/3 inch
Megapixel	5 MP
Field of View (FOV)	12.1mm X 10.1mm@ 5M CCD
Telecentric Type	Object Side
Telecentricity	0.02 °
Optical Distortion (max.)	0.012 %
Special Feature	Super High Res

