

# BP2824S13C

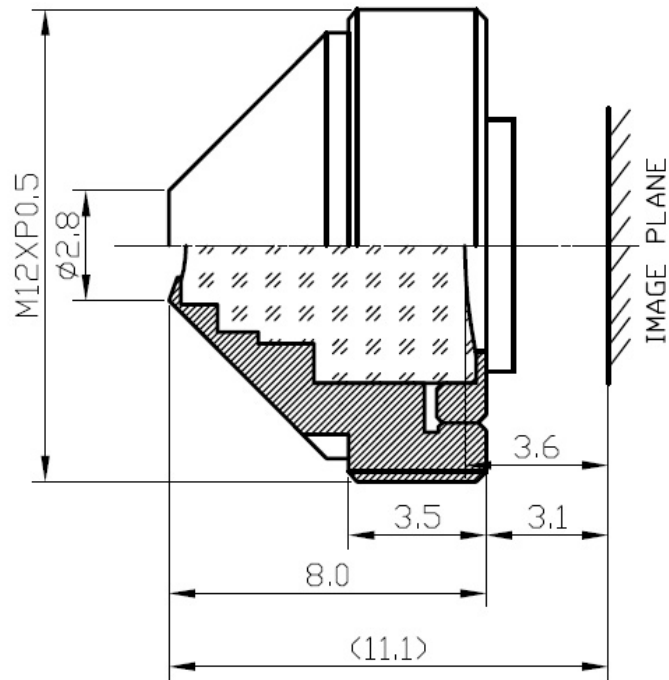

The S-Mount lens Lensagon BP2824S13C is suitable for sensors below 1 megapixel with an image format of 1/3 inch.



## Technical Data

Mount	S-Mount
Sensor	1/3 inch
Focal Length	2.8 mm
Aperture	2.4
MOD	0.3 m
Back Focal	3.6 mm
Angle of View	D:125° H:82° V:56°
IR Cut Filter	Yes
Iris	fixed
Focus	fixed
Typ	Pinhole

**SEDECO**  
IMAGING

Germany, Austria, Switzerland  
Sedeco Imaging GmbH  
Unterer Dammweg 12  
76149 Karlsruhe  
Germany  
T. +49 721 5604 7980  
info@sedeco-imaging.com

BeNeLux  
Sedeco Imaging B.V.  
Trasmolenlaan 12  
3447 GZ Woerden  
the Netherlands  
T. +31 348 749110  
info@sedeco-imaging.nl

[www.sedeco-imaging.com](http://www.sedeco-imaging.com)

