

# MV-CE200-11UM

20 MP 1" CMOS USB3.0 Area Scan Camera



**GEN*i*CAM**

**USB<sup>TM</sup>**  
VISION

## Introduction

MV-CE200-11UM camera adopts Sony IMX183 sensor to provide high-quality image. It uses USB3.0 interface to transmit non-compressed images in real time with max. frame rate reaching 14 fps.

## Key Feature

- Supports auto and manual adjustment for gain, exposure control, white balance, LUT, Gamma correction, etc.
- Supports hardware triggering, software triggering and free run mode
- Adopts M2 screw holes for securing cable that connects USB3.0 interface
- Compatible with USB3 Vision Protocol, GenICam Standard, and the third-party software based on these protocol and standard

## Available Model

Mono camera: MV-CE200-11UM

## Applicable Industry

SMT/ PCB AOI, FPD, etc.

## Sensor Quantum Efficiency

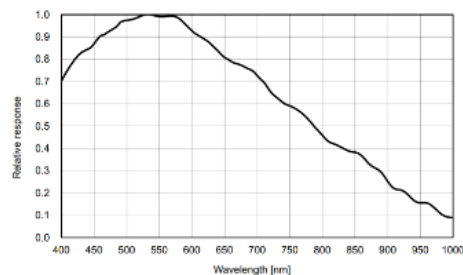

## Dimension

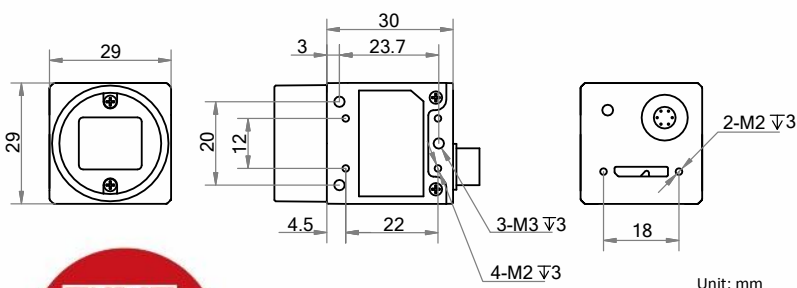

## Specification

<b>Model</b>	<b>MV-CE200-11UM</b>
<b>Camera</b>	
<b>Sensor type</b>	CMOS, rolling shutter
<b>Sensor model</b>	Sony IMX183
<b>Pixel size</b>	2.4 $\mu\text{m}$ $\times$ 2.4 $\mu\text{m}$
<b>Sensor size</b>	1"
<b>Resolution</b>	5472 $\times$ 3648
<b>Max. frame rate</b>	14 fps @5472 $\times$ 3648
<b>Dynamic range</b>	65.5 dB
<b>SNR</b>	41.5 dB
<b>Gain</b>	0 dB to 20 dB
<b>Exposure time</b>	19 $\mu\text{s}$ to 1 s
<b>Shutter mode</b>	Off/Once/Continuous exposure mode
<b>Mono/color</b>	Mono
<b>Pixel format</b>	Mono 8/10/10p/12/12p
<b>Binning</b>	Supports 1 $\times$ 2, 1 $\times$ 4, 2 $\times$ 1, 2 $\times$ 2, 2 $\times$ 4, 4 $\times$ 1, 4 $\times$ 2, 4 $\times$ 4
<b>Decimation</b>	Supports 1 $\times$ 2, 1 $\times$ 4, 2 $\times$ 1, 2 $\times$ 2, 2 $\times$ 4, 4 $\times$ 1, 4 $\times$ 2, 4 $\times$ 4
<b>Reverse image</b>	Supports horizontal reverse image output
<b>Image buffer</b>	128 MB
<b>Electrical features</b>	
<b>Data interface</b>	USB3.0
<b>Digital I/O</b>	6-pin Hirose connector provides power and I/O, including Opto-isolated input x 1 (Line 0), Opto-isolated output x 1 (Line 1), bi-directional non-isolated I/O x 1 (Line 2)
<b>Power supply</b>	5 VDC to 15 VDC, supports USB3.0 power supply
<b>Power consumption</b>	< 2.83 W@12 VDC
<b>Structure</b>	
<b>Lens mount</b>	C-Mount
<b>Dimension</b>	29 mm $\times$ 29 mm $\times$ 30 mm (1.1" $\times$ 1.1" $\times$ 1.2")
<b>Weight</b>	Approx. 80 g (0.2 lb.)
<b>Ingress protection</b>	IP30 (under proper lens installation and wiring)
<b>Temperature</b>	Working temperature: 0 $^{\circ}\text{C}$ to 50 $^{\circ}\text{C}$ (32 $^{\circ}\text{F}$ to 122 $^{\circ}\text{F}$ ) Storage temperature: -30 $^{\circ}\text{C}$ to 70 $^{\circ}\text{C}$ (-22 $^{\circ}\text{F}$ to 158 $^{\circ}\text{F}$ )
<b>Humidity</b>	20% to 80% RH, without condensation
<b>General</b>	
<b>Client software</b>	MVS or third-party software meeting with USB3 Vision Protocol
<b>Operating system</b>	32/64-bit Windows XP/7/10 and 32/64-bit Linux
<b>Compatibility</b>	USB3 Vision, GenICam
<b>Certification</b>	CE, FCC, RoHS, KC

### HIKROBOT

Hangzhou Hikrobot Technology Co., Ltd.  
No.399 Danfeng Road, Binjiang District, Hangzhou 310051, China.  
en.hikrobotics.com

**SEDECO**  
IMAGING

Germany, Austria, Switzerland  
Sedeco Imaging GmbH  
Unterer Dammweg 12  
76149 Karlsruhe  
Germany  
T. +49 721 5604 7980  
info@sedeco-imaging.com

BeNeLux  
Sedeco Imaging B.V.  
Trasmolenlaan 12  
3447 GZ Woerden  
the Netherlands  
T. +31 348 749110  
info@sedeco-imaging.nl

[www.sedeco-imaging.com](http://www.sedeco-imaging.com)

Copyright Hikrobot

Hangzhou Hikrobot Technology Co., Ltd. All Rights Reserved. Hangzhou Hikrobot Technology does not tolerate any infringement. Any organization or individual may not imitate or reproduce in whole or in part of the content. The data herein is based on Hikrobot's internal evaluation. Actual data may vary depending on specific configuration and operating condition. The information herein is subject to change without notice. All the content has been checked conscientiously. Nevertheless, Hikrobot shall not be liable to damages resulting from errors, inconsistencies or omissions.