

## MV-CE200-10UM/UC

20 MP 1" CMOS USB3.0 Area Scan Camera

### Introduction

MV-CE200-10UM/UC camera adopts Sony IMX183 sensor to provide high-quality image. It uses USB3.0 interface to transmit non-compressed images in real time with max. frame rate reaching 14 fps.



### Key Feature

- Supports gain adjustment, exposure time, white balance, LUT, Gamma correction and binning
- Supports hardware triggering, software triggering and free run mode
- Adopts M2 screw holes for securing cable that connects USB3.0 interface
- Compatible with USB3 Vision Protocol, GenlCam Standard, and the third-party software based on these and standard

**GEN*<i>i>*CAM**

**USB<sup>™</sup>  
VISION**

### Available Model

- Mono Camera: MV-CE200-10UM
- Color Camera: MV-CE200-10UC

### Applicable Industry

Electronic semiconductor, factory automation, medical packaging, etc.

### Sensor Quantum Efficiency

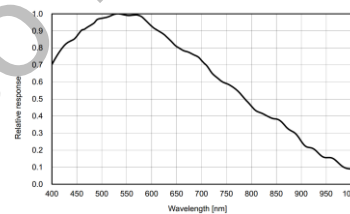

MV-CE200-10UM

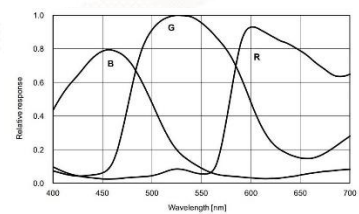

MV-CE200-10UC

### Dimension

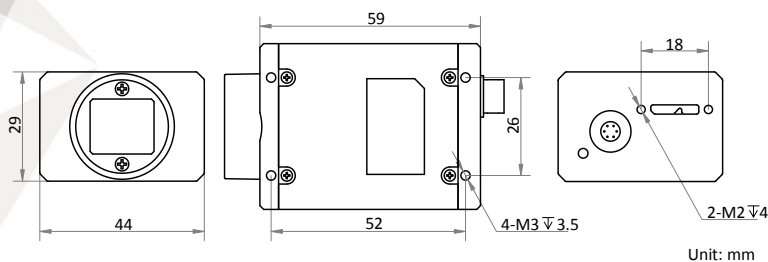

## Specification

Model	MV-CE200-10UM	MV-CE200-10UC
<b>Camera</b>		
Sensor type	CMOS, rolling shutter	
Sensor model	Sony IMX183	
Pixel size	2.4 $\mu\text{m}$ $\times$ 2.4 $\mu\text{m}$	
Sensor size	1"	
Resolution	5472 $\times$ 3648	
Frame rate	14 fps	
Dynamic range	65.5 dB	
SNR	41.5 dB	
Gain	0 dB to 20 dB	
Exposure time	19 $\mu\text{s}$ to 1 s	44 $\mu\text{s}$ to 1 s
Shutter mode	Off/Once/Continuous exposure mode	
Mono/color	Mono	Color
Pixel format	Mono 8/10/10p/12/12p	Mono 8/10/12, Bayer GB 8/10/10p/12/12p, YUV422Packed, YUV422_YUYV_Packed, RGB8
Binning	Supports 1 $\times$ 2, 2 $\times$ 1, 1 $\times$ 4, 4 $\times$ 1, 2 $\times$ 2, 2 $\times$ 4, 4 $\times$ 2, 4 $\times$ 4	
Decimation	Supports 1 $\times$ 2, 2 $\times$ 1, 1 $\times$ 4, 4 $\times$ 1, 2 $\times$ 2, 2 $\times$ 4, 4 $\times$ 2, 4 $\times$ 4	
Reverse image	Supports horizontal reverse image output	
Image buffer	128 MB	
<b>Electrical features</b>		
Data interface	USB3.0	
Digital I/O	6-pin Hirose connector provides power and I/O, including opto-isolated input x 1 (Line0), opto-isolated output x 1 (Line1), bi-directional non-isolated I/O x 1 (Line2)	
Power supply	5 VDC to 15 VDC, supports USB3.0 power supply	
Power consumption	Approx. 2.83 W@5 VDC	
<b>Structure</b>		
Lens mount	C-Mount	
Dimension	44 mm $\times$ 29 mm $\times$ 59 mm (1.7" $\times$ 1.1" $\times$ 2.3")	
Weight	Approx. 100 g (0.2 lb.)	
Ingress protection	IP30 (under proper lens installation and wiring)	
Temperature	Working temperature: 0 $^{\circ}\text{C}$ to 50 $^{\circ}\text{C}$ (32 $^{\circ}\text{F}$ to 122 $^{\circ}\text{F}$ ) Storage temperature: -30 $^{\circ}\text{C}$ to 70 $^{\circ}\text{C}$ (-22 $^{\circ}\text{F}$ to 158 $^{\circ}\text{F}$ )	
Humidity	20% to 80% RH, without condensation	
<b>General</b>		
Client software	MVS or third-party software meeting with USB3.0 Vision Protocol	
Operating system	32/64-bit Windows XP/7/10, 32/64-bit Linux	
Compatibility	USB3 Vision, GenICam	
Certification	CE, FCC, RoHS, KC	



Germany, Austria, Switzerland  
 Sedeco Imaging GmbH  
 Unterer Dammweg 12  
 76149 Karlsruhe  
 Germany  
 T. +49 721 5604 7980  
 info@sedeco-imaging.com

BeNeLux  
 Sedeco Imaging B.V.  
 Trasmolenlaan 12  
 3447 GZ Woerden  
 the Netherlands  
 T. +31 348 749110  
 info@sedeco-imaging.nl

[www.sedeco-imaging.com](http://www.sedeco-imaging.com)