

## MV-CH089-10UM/UC

8.9 MP 1" CMOS USB3.0 Area Scan Camera

### Introduction

MV-CH089-10UM/UC camera adopts Sony IMX267 sensor to provide high-quality image. It uses USB3.0 interface to transmit non-compressed images in real time with max. frame rate reaching 32 fps.



### Key Feature

- Supports auto and manual adjustment for gain, exposure control, white balance, LUT, Gamma correction, etc.
- Supports hardware triggering, software triggering and free run mode
- Adopts M2 screw holes for securing cable that connects USB3.0 interface
- Compatible with USB3 Vision Protocol, GenCam Standard, and the third-party software based on these protocol and standard

**GEN<i>i</i>CAM**

**USB<sup>™</sup>**  
VISION

### Available Model

- Mono Camera: MV-CH089-10UM
- Color Camera: MV-CH089-10UC

### Applicable Industry

Electronic semiconductor, factory automation, bottle inspection, medical packaging, etc.

### Sensor Quantum Efficiency

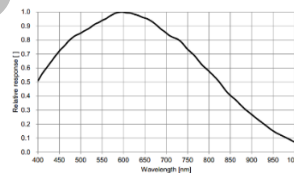

MV-CH089-10UM

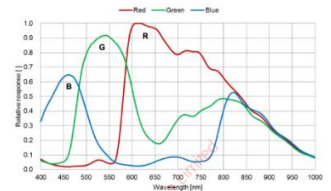

MV-CH089-10UC

### Dimension

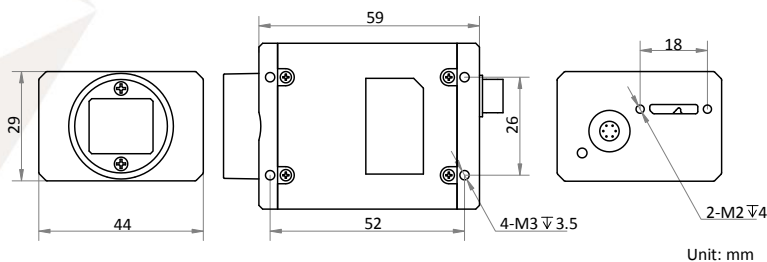

Unit: mm



## Specification

Model	MV-CH089-10UM	MV-CH089-10UC
<b>Camera</b>		
Sensor type	CMOS, global shutter	
Sensor model	Sony IMX267	
Pixel size	3.45 μm × 3.45 μm	
Sensor size	1"	
Resolution	4096 × 2160	
Frame rate	32 fps	
Dynamic range	72.5 dB	
SNR	40.1 dB	
Gain	0 dB to 20 dB	
Exposure time	50 μs to 10 s	
Shutter mode	Off/Once/Continuous exposure mode	
Mono/color	Mono	Color
Pixel format	Mono 8/10/10p/12/12p	Mono 8/10/12, Bayer GB 8/10/10p/12/12p, YUV422Packed, YUV422_YUYV_Packed, RGB8
Acquisition mode	Continuous mode and SingleFrame mode	
Binning	Supports 1 × 2, 2 × 1, 1 × 4, 4 × 1, 2 × 2, 2 × 4, 4 × 2, 4 × 4	
Decimation	Supports 1 × 2, 2 × 1, 2 × 2	
Reverse image	Supports horizontal and vertical reverse image output	
Image buffer	128 MB	
<b>Electrical features</b>		
Data interface	USB3.0	
Digital I/O	6-pin Hirose connector provides power and I/O, including opto-isolated input x 1 (Line0), opto-isolated output x 1 (Line1), bi-directional non-isolated I/O x 1 (Line2)	
Power supply	5 VDC to 15 VDC, supports USB3.0 power supply	
Power consumption	< 3.27 W@5 VDC	
<b>Structure</b>		
Lens mount	C-Mount	
Dimension	44 mm × 29 mm × 59 mm (1.7" × 1.1" × 2.3")	
Weight	Approx. 100 g (0.2 lb.)	
Ingress protection	IP30 (under proper lens installation and wiring)	
Temperature	Working temperature: 0 °C to 50 °C (32 °F to 122 °F) Storage temperature: -30 °C to 70 °C (-22 °F to 158 °F)	
Humidity	20% to 80% RH, without condensation	
<b>General</b>		
Client software	MVS or third-party software meeting with USB3.0 Vision Protocol	
Operating system	32/64-bit Windows XP/7/10, 32/64-bit Linux	
Compatibility	USB3 Vision, GenICam	
Certification	CE, FCC, RoHS, KC	



<p><b>Germany, Austria, Switzerland</b>  <b>Sedeco Imaging GmbH</b>          Unterer Dammweg 12          76149 Karlsruhe          Germany          T. +49 721 5604 7980          info@sedeco-imaging.com</p>	<p><b>BeNeLux</b>  <b>Sedeco Imaging B.V.</b>          Trasmolenlaan 12          3447 GZ Woerden          the Netherlands          T. +31 348 749110          info@sedeco-imaging.nl</p>
--	--

[www.sedeco-imaging.com](http://www.sedeco-imaging.com)