

MV-CH120-10UM/UC

12 MP 1.1" CMOS USB3.0 Area Scan Camera

Introduction

MV-CH120-10UM/UC camera adopts Sony IMX304 sensor to provide high-quality image. It uses USB3.0 interface to transmit non-compressed images in real time with max. frame rate reaching 23 fps.



GEN*i*CAM

**USB
VISION**

Key Feature

- Supports auto and manual adjustment for gain, exposure control, white balance, LUT, Gamma correction, etc.
- Supports hardware triggering, software triggering and free run mode
- Adopts M2 screw holes for securing cable that connects USB3.0 interface
- Compatible with USB3 Vision Protocol, GenCam Standard, and the third-party software based on these protocol and standard

Available Model

- Mono: MV-CH120-10UM
- Color: MV-CH120-10UC

Applicable Industry

Electronic semiconductor, factory automation, bottle inspection, medical packaging, etc

Sensor Quantum Efficiency

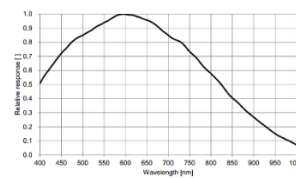

MV-CH120-10UM

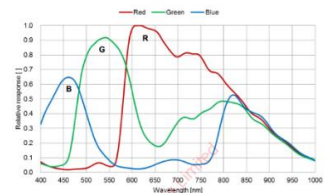

MV-CH120-10UC

Dimension

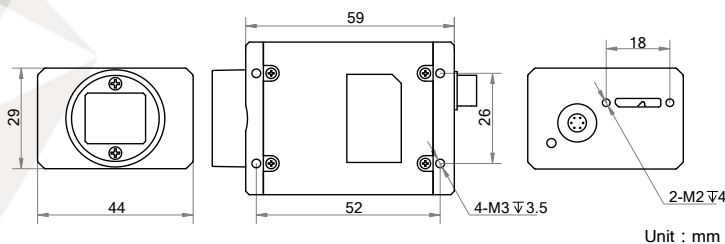

Specification

Model	MV-CH120-10UM	MV-CH120-10UC
Camera		
Sensor type	CMOS, global shutter	
Sensor model	Sony IMX304	
Pixel size	3.45 μm \times 3.45 μm	
Sensor size	1.1"	
Resolution	4096 \times 3000	
Maximum frame rate	23 fps	
Dynamic range	72.2 dB	
SNR	40.2 dB	
Gain	0 dB to 20 dB	
Exposure time	50 μs to 10 s	
Shutter mode	Off/Once/Continuous exposure mode	
Mono/color	Mono	Color
Pixel format	Mono 8/10/10p/12/12p	Mono 8/10/12, Bayer GB 8/10/10p/12/12p, YUV422Packed, YUV422_YUYV_Packed, RGB8
Acquisition mode	Continuous mode and SingleFrame mode	
Binning	Supports 1 \times 2, 1 \times 4, 2 \times 1, 2 \times 2, 2 \times 4, 4 \times 1, 4 \times 2, 4 \times 4	
Decimation	Supports 1 \times 2, 1 \times 4, 2 \times 1, 2 \times 2, 2 \times 4, 4 \times 1, 4 \times 2, 4 \times 4	
Reverse image	Supports horizontal and vertical reverse image output	
Image buffer	128 MB	
Electrical features		
Data interface	USB 3.0	
Digital I/O	6-pin Hirose connector provides power and I/O, including opto-isolated input x 1 (Line0), opto-isolated output x 1 (Line1), bi-directional non-isolated I/O x 1 (Line2)	
Power supply	5 VDC to 15 VDC, supports USB3.0 power supply	
Power consumption	< 3.5 W@5 VDC	
Structure		
Lens mount	C-Mount	
Dimension	44 mm \times 29 mm \times 59 mm (1.7" \times 1.1" \times 2.3")	
Weight	Approx. 100 g (0.2 lb.)	
Ingress protection	IP30 (under proper lens installation and wiring)	
Temperature	Working temperature: 0 $^{\circ}\text{C}$ to 50 $^{\circ}\text{C}$ (32 $^{\circ}\text{F}$ to 122 $^{\circ}\text{F}$) Storage temperature: -30 $^{\circ}\text{C}$ to 70 $^{\circ}\text{C}$ (-22 $^{\circ}\text{F}$ to 158 $^{\circ}\text{F}$)	
Humidity	20% to 80% RH, without condensation	
General		
Client software	MVS or third-party software meeting with USB 3.0 Vision Protocol	
Operating system	32/64-bit Windows XP/7/10, 32/64-bit Linux	
Compatibility	USB 3.0 Vision, GenICam	
Certification	CE, FCC, RoHS, KC	

<p>Germany, Austria, Switzerland Sedeco Imaging GmbH Unterer Dammweg 12 76149 Karlsruhe Germany T. +49 721 5604 7980 info@sedeco-imaging.com</p>	<p>BeNeLux Sedeco Imaging B.V. Trasmolenlaan 12 3447 GZ Woerden the Netherlands T. +31 348 749110 info@sedeco-imaging.nl</p>
---	---

www.sedeco-imaging.com