

MV-CH500-61CM-M58S-TF

50 MP CCD CameraLink Area Scan Camera

Introduction

MV-CH500-61CM-M58S-TF camera adopts OnSemi KAI-50140 sensor to provide high-quality image. It uses CameraLink interface to transmit non-compressed images in real time with max. frame rate reaching 4 fps. The camera adopts TEC to keep the camera's sensor temperature around environment temperature.



GEN*i*CAM



Key Feature

- Resolution of 10440 × 4800 and pixel size of 4.5 μm × 4.5 μm
- Adopts global shutter CCD sensor providing wide dynamic range and high-quality image
- Supports configuration modes of Base and Medium via the CameraLink interface
- Adopts compact design with mounting holes for flexible mounting

Applicable Industry

FPD, electronics and semiconductor inspection, research and scientific imaging, microscopy and metrology, etc.

Available Model

Mono camera: MV-CH500-61CM-M58S-TF

Dimension

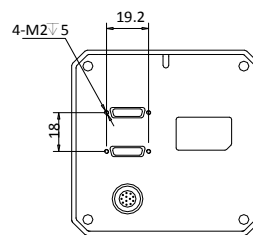
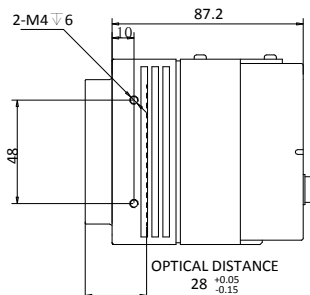
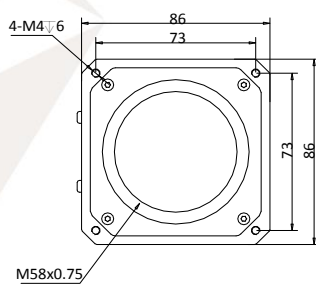

Unit: mm

Sensor Quantum Efficiency

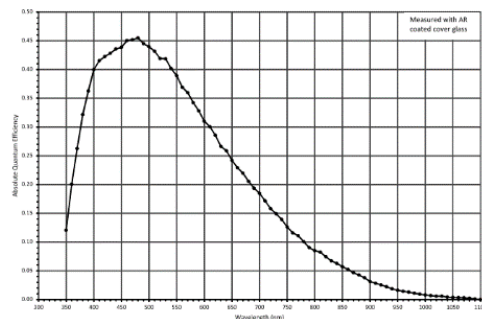

Specification

Model	MV-CH500-61CM-M58S-TF	
Camera		
Sensor type	CCD, global shutter	
Sensor model	OnSemi KAI-50140	
Pixel size	4.5 μm \times 4.5 μm	
Sensor size	46.98 mm \times 21.6 mm	
Resolution	10440 \times 4800	
Pixel clock	85 MHz	
Configuration mode	Base	Medium
Sensor combination	1X_2YE	1X2_2YE
Tap number	2 Taps	4 Taps
Frame rate	4 fps	
Pixel format	Mono 8/10/12	
Dynamic range	60 dB	
SNR	40 dB	
Gain	0 dB to 20 dB	
Exposure time	102 μs to 10 s	
Shutter mode	Off/Once/Continuous exposure mode	
Mono/color	Mono	
Reverse image	Supports horizontal reverse image output	
Electrical features		
Data interface	CameraLink with SDR interface	
Digital I/O	12-pin Hirose connector provides power and I/O, including opto-isolated input x 1 (Line0), opto-isolated output x 1 (Line1), RS232 x 1	
Power supply	22 VDC to 26 VDC	
Power consumption	Approx. 18 W@24 VDC (Non-TEC cooling mode) Approx. 70 W@24 VDC (TEC cooling mode)	
Structure		
Lens mount	M58-mount, optical back focal length 28 mm (1.1")	
Dimension	86 mm \times 86 mm \times 87.2 mm (3.4" \times 3.4" \times 3.4")	
Weight	Approx. 1300 g (2.9 lb.)	
Ingress protection	IP40 (under proper lens installation and wiring)	
Temperature	Working temperature: 0 $^{\circ}\text{C}$ to 50 $^{\circ}\text{C}$ (32 $^{\circ}\text{F}$ to 122 $^{\circ}\text{F}$) Storage temperature: -30 $^{\circ}\text{C}$ to 70 $^{\circ}\text{C}$ (-22 $^{\circ}\text{F}$ to 158 $^{\circ}\text{F}$)	
Humidity	20% to 95% RH, without condensation	
General		
Client software	MVS or frame grabber software meeting with CameraLink V2.0, GenICam Protocol	
Operating system	32/64-bit Windows XP/7/10	
Compatibility	CameraLink, GenICam	
Certification	CE, FCC, KC	



<p>Germany, Austria, Switzerland Sedeco Imaging GmbH Unterer Dammweg 12 76149 Karlsruhe Germany T. +49 721 5604 7980 info@sedeco-imaging.com</p>	<p>BeNeLux Sedeco Imaging B.V. Trasmolenlaan 12 3447 GZ Woerden the Netherlands T. +31 348 749110 info@sedeco-imaging.nl</p>
www.sedeco-imaging.com	