

**MV-CH080-60GM/GC**  
**8MP, 4/3" CCD, GigE Camera**



The Hikvision MV-CH080-60GM/GC 8 MP 4/3" CCD GigE Camera is a high quality device that can be used in a variety of applications, including SMT automatic optical detection, PCB AOI, FPD detection, railway related applications and etc.

**Key Features**

- 8 MP resolution, pixel size of 5.5µm
- High quality CCD sensor with ultra high signal-to-noise ratio, wide dynamic range, excellent imaging quality
- 128 MB on-board buffer, which enable to cache multiple pictures for data transmission or image retransmitting in Burst mode
- GigE interface, with the maximum transmission distance of 100 m (without relay)
- Support serial port communication, communication protocol RS232 or full-duplex RS485
- M58 optical mount, applicable for F/V mount
- Compact construction design with mounting holes on the up and bottom panels for flexible mounting

**Application Scenarios**

- SMT automatic optical detection
- PCB AOI
- FPD detection
- Railway related applications

**Spectral Response**

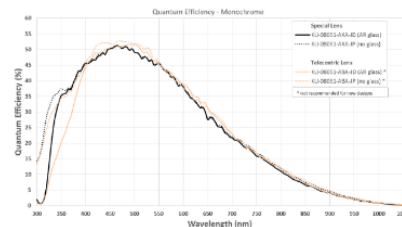

MV-CH080-60GM Quantum Efficiency

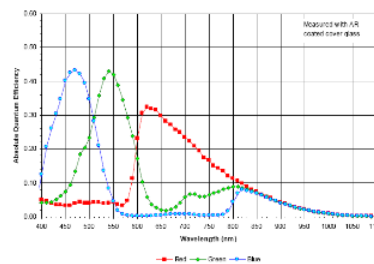

MV-CH080-60GC Quantum Efficiency

**Order Models**

- Mono: MV-CH080-60GM
- Color: MV-CH080-60GC



## Specifications

Model	MV-CH080-60GM	MV-CH080-60GC
Parameters	8MP, 4/3" CCD, GigE Camera	
<b>Camera</b>		
Sensor	KA108051	
Pixel Size	5.5µm×5.5µm	
Sensor Size	4/3"	
Resolution	3296×2472	
Frame Rate	14fps	
Dynamic Range	>66dB	
SNR	>40dB	
Gain Range	0-20dB	
Exposure Time	50µs-1sec	
Shutter Mode	Global Shutter. Auto-Exposure, Manual Exposure, One-key Exposure	
Data Interface	Gigabit Ethernet	
General Purpose I/O	12 pin IO, Opto-isolated input x1, Opto-isolated output x1, Bi-directional non-isolated I/O x1, RS232 x1, full-duplex RS485 x1	
Image Buffer	128MB	
Data Format	Mono 8/10/10p/12/12p	Mono 8/10/12, Bayer RG 8/10/10p/12/12p, YUV 422 Packed, YUV422_YUYV_Packed, RGB 8
<b>General</b>		
Power	< 12W@12VDC, using 12VDC @2A switching power or power adapter	
Temperature	Working Temperature 0~50°C, Storage Temperature -30~70°C	
Humidity	20%-80%RH without condensation	
Dimension	74mm×74mm×50mm	
Weight	< 410g	
Lens Interface	M58*0.75, optical back focal length 11.48 mm, supporting C-mount or F-mount via lens adapter	
Software	MVS or Third-Party Software supporting GigE Vision Protocol	
Operating System	Windows XP/7/10 32/64bits	
Compliance	GigE Vision	
Certification	CE, FCC, RoHS	

**SEDECO**  
IMAGING

Germany, Austria, Switzerland  
Sedeco Imaging GmbH  
Unterer Dammweg 12  
76149 Karlsruhe  
Germany  
T. +49 721 5604 7980  
info@sedeco-imaging.com

BeNeLux  
Sedeco Imaging B.V.  
Trasmolenlaan 12  
3447 GZ Woerden  
the Netherlands  
T. +31 348 749110  
info@sedeco-imaging.nl

[www.sedeco-imaging.com](http://www.sedeco-imaging.com)

### Dimensions

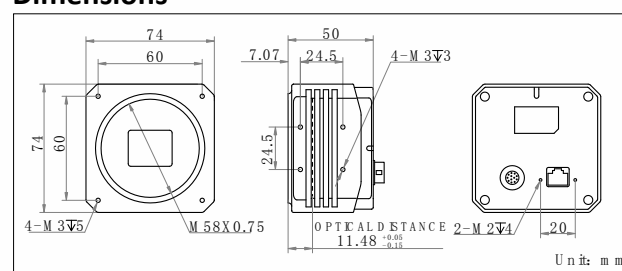

### Recommended Accessories

- **Power:** 12VDC @2A power adapter
- **NIC:** Intel Pro1000 and above version recommended
- **Network Cable:** CAT5e or CAT6 network cable recommended