

MV-CA060-10GM/GC
6MP, 1/1.8" CMOS, GigE Camera



The Hikvision MV-CA060-10GM/GC 6 MP 1/1.8" CMOS GigE Camera is a high quality device that can be used in a variety of applications, including electronic semiconductor fabrication, factory automation, quality inspection.

Key Features

- Gigabit Ethernet interface providing 1Gbps bandwidth; Transmitting distance can be 100m without relaying.
- 128MB on-board buffer, for image burst transmitting and retransmitting.
- Support auto exposure control, LUT and Gamma correction.
- Cameras can be synchronized with hard trigger and soft trigger.
- Different exposure modes can be used to capture image.
- Embed special color interpolation algorithm which reproduces color performance better and supports auto white balance function.
- Compliant with GigE Vision V1.2, can be supported by third party software.

Application Scenarios

- Electronic semiconductor
- Factory automation
- Quality Inspection

Spectral Response

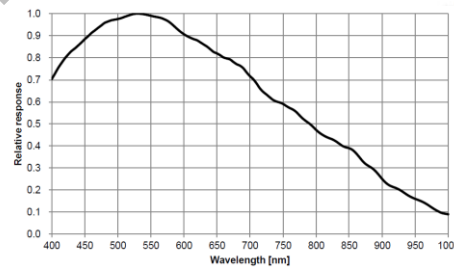

MV-CA060-10GM Quantum Efficiency

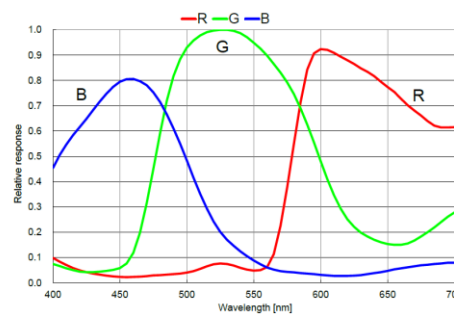

MV-CA060-10GC Quantum Efficiency

Order Models

- Mono: MV-CA060-10GM
- Color: MV-CA060-10GC



Specifications

Model	MV-CA060-10GM	MV-CA060-10GC
Parameters	6MP, 1/1.8" CMOS, GigE Camera	
Camera		
Sensor	IMX178	
Pixel Size	2.4μm×2.4μm	
Sensor Size	1/1.8"	
Resolution	3072x2048	
Frame Rate	17fps	
Dynamic Range	>65dB	
SNR	>40dB	
Gain Range	0-20dB	
Exposure Time	27μs-2.5sec	
Shutter Mode	Rolling shutter. Auto-exposure, Manual exposure, and One-key exposure	
Data Interface	Gigabit Ethernet	
General Purpose I/O	Opto-isolated input x1, Opto-isolated output x1, Bi-directional non-isolated I/O x1	
Image Buffer	128MB	
Data Format	Mono8/10/10p/12/12p	Mono8/10/12, RGB8, Bayer RG 8/10/10p/12/12p, YUV 422 8 UYVY, YUV 422 8
General		
Power	Approx. 3.5W@12VDC, Voltage 5~15VDC, PoE supported	
Temperature	Working Temperature 0-50°C, Storage Temperature -30-70°C	
Humidity	20%-80% RH without condensation	
Dimension	29mm×29mm×42mm	
Weight	Approx. 68g	
Lens Interface	C-Mount	
Software	MVS or Third-Party Software supporting GigE Vision Protocol	
Operating System	Windows XP/7/10 32/64bits	
Compliance	GigE Vision	
Certification	CE, FCC, RoHS	

Dimensions

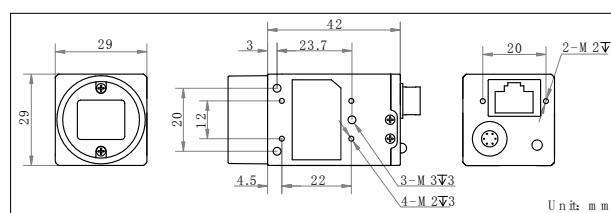

Recommended Accessories

- **Power:** 12VDC @1A power adapter
- **NIC:** Intel Pro1000 and above version recommended
- **Network Cable:** CAT5e or CAT6 network cable recommended

SEDECO
IMAGING

Germany, Austria, Switzerland
Sedeco Imaging GmbH
Unterer Dammweg 12
76149 Karlsruhe
Germany
T. +49 721 5604 7980
info@sedeco-imaging.com

BeNeLux
Sedeco Imaging B.V.
Trasmolenlaan 12
3447 GZ Woerden
the Netherlands
T. +31 348 749110
info@sedeco-imaging.nl

www.sedeco-imaging.com