

MV-CA004-10GM/GC

0.4 MP 1/2.9" CMOS GigE Area Scan Camera

Introduction

MV-CA004-10GM/GC adopts Sony IMX 287 CMOS sensor and provides high quality image. The GigE interface provides high-speed real-time transmission of uncompressed data with the maximum frame rate reaching 312.9 fps at full resolution.



GIGEVISION

GENiCAM

Key Feature

- Adopts GigE interface and max. transmission distance of 100 meters without relay
- Supports auto and manual adjustment for gain, exposure control, white balance, LUT, Gamma correction, and etc.
- Up to 128 MB local memory for burst transmission and retransmission
- Compatible with GigE Vision Protocol V2.0, GeniCam standard and third-party software meeting with GigE Vision Protocol

Sensor Quantum Efficiency

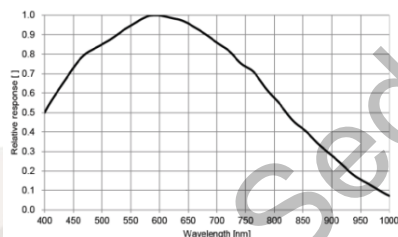

MV-CA004-10GM

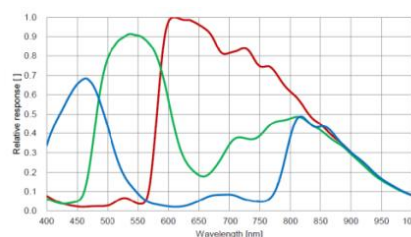

MV-CA004-10GC

Available Model

- Mono camera: MV-CA004-10GM
- Color camera: MV-CA004-10GC

Dimension

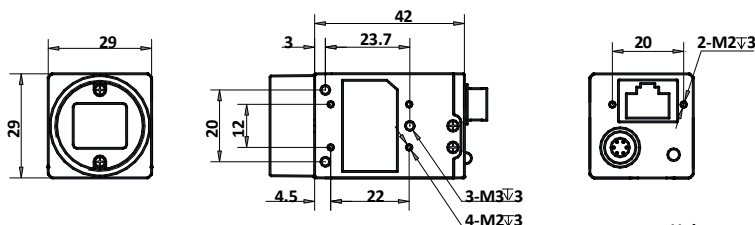

Unit: mm



Specification

Model	MV-CA004-10GM	MV-CA004-10GC
Parameters	0.4 MP 1/2.9" CMOS GigE Area Scan Camera	
Camera		
Sensor type	CMOS, global shutter	
Sensor model	Sony IMX287	
Pixel size	6.9 μm \times 6.9 μm	
Sensor size	1/2.9"	
Resolution	720 \times 540	
Frame rate	Mono8 312.9fps	Bayer8 312.9fps
Dynamic range	74 dB	
SNR	41 dB	
Gain	0 dB to 20 dB	
Exposure time	1 μs to 10 s	
Shutter mode	Off/ Once/ Continuous exposure mode	
Acquisition mode	Continuous mode, single frame mode	
Binning	Not supported	
Decimation	Not supported	
Reverse image	Supports horizontal and vertical reverse image	
Image buffer	128 MB	
Data format	Mono 8/10/10p/12/12p	Mono 8/10/12, Bayer GR 8/10/10p/12/12p YUV 422 Packed, YUV422_YUYV_Packed, RGB8
Electrical features		
Data interface	Gigabit Ethernet	
Digital I/O	6-pin Hirose connector provides power supply and I/O, including opto-isolated Input x 1 (Line 0), opto-isolated Output x 1 (Line 1), bi-directional non-isolated I/O x 1 (Line 2)	
Power	3.1 W@12 VDC, voltage range 9 VDC to 26 VDC; supports PoE power supply	
Structure		
Lens mount	C-Mount	
Dimension	29 mm \times 29 mm \times 42 mm (1.1" \times 1.1" \times 1.7")	
Weight	Approx. 68 g (0.15 lb.)	
Ingress Protection	IP 30 (only when lens is correctly mounted and cables are correctly connected)	
Temperature	Working temperature: 0 $^{\circ}\text{C}$ to 50 $^{\circ}\text{C}$ (32 $^{\circ}\text{F}$ to 122 $^{\circ}\text{F}$) Storage temperature: -30 $^{\circ}\text{C}$ to 70 $^{\circ}\text{C}$ (-22 $^{\circ}\text{F}$ to 158 $^{\circ}\text{F}$)	
Humidity	20% to 80% without condensation	
General		
Client software	MVS or third-party software meeting with GigE Vision Protocol	
Operation system	32/64-bit Windows XP/7/10, 32/64-bit Linux or 64-bit MacOS	
Compatibility	GigE Vision V2.0, GenICam	
Certifications	CE, FCC, RoHS	

Germany, Austria, Switzerland
 Sedeco Imaging GmbH
 Unterer Dammweg 12
 76149 Karlsruhe
 Germany
 T. +49 721 5604 7980
 info@sedeco-imaging.com

BeNeLux
 Sedeco Imaging B.V.
 Trasmolenlaan 12
 3447 CZ Woerden
 the Netherlands
 T. +31 348 749110
 info@sedeco-imaging.nl

www.sedeco-imaging.com