

# TC4MHR-026-200I

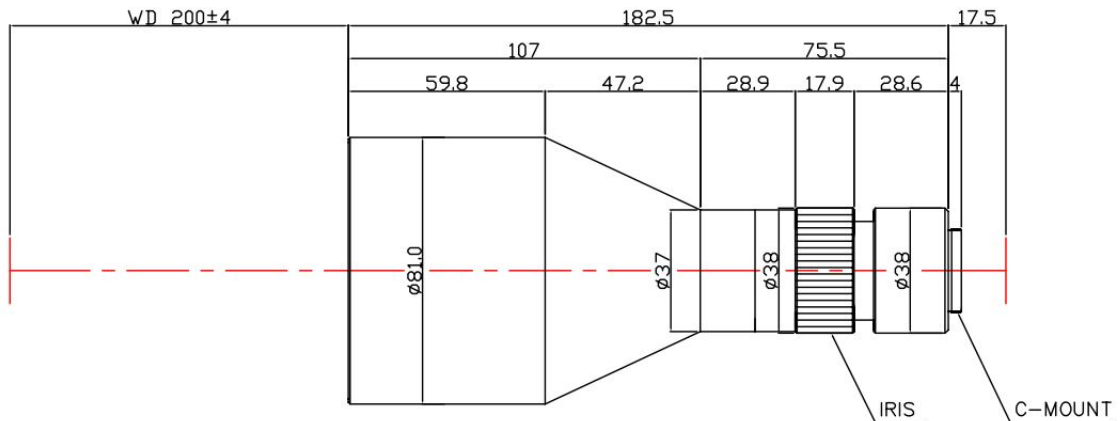

The Object Side Telecentric Lens TC4MHR-026-200I is suitable for sensors up to 4 megapixel and with an image format of 1 inch.

## Technical Data

Magnification	0.26 X
Mount Type	C-Mount
Aperture (F)	5.6
Working Distance (WD)	200
Depth of Field (DOF)	3644 µm
Resolution (Object Side)	14.3 µm
Numerical Aperture (NA)	0.0234
Image Format (max.)	1 inch
Megapixel	4 MP
Field of View (FOV)	43.3mm X 43.3mm @ 4M CCD
Telecentric Type	Object Side
Telecentricity	0.03 °
Optical Distortion (max.)	0.031 %
Special Feature	High Res

