

**MV-CA023-10GM/GC**  
**2.3MP, 1/1.2" CMOS, GigE Camera**



The Hikvision MV-CA023-10GM/GC 2.3 MP 1/1.2" CMOS GigE Camera is a high quality device that can be used in a variety of applications, including electronic semiconductor fabrication, factory automation, quality inspection.

**Key Features**

- Gigabit Ethernet interface providing 1Gbps bandwidth; Transmitting distance can be 100m without relaying.
- 128MB on-board buffer, for image burst transmitting and retransmitting.
- Support auto exposure control, LUT and Gamma correction.
- Cameras can be synchronized with hard trigger and soft trigger.
- Different exposure modes can be used to capture image.
- Embed special color interpolation algorithm which reproduces color performance better and supports auto white balance function.
- Compliant with GigE Vision V1.2, can be supported by third party software.

**Application Scenarios**

- Electronic semiconductor
- Factory automation
- Quality Inspection

**Spectral Response**

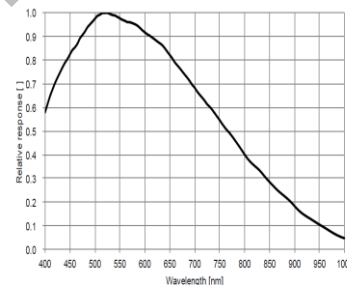

MV-CA023-10GM Quantum Efficiency

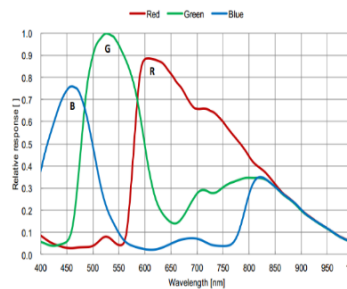

MV-CA023-10GC Quantum Efficiency

**Order Models**

- Mono: MV-CA023-10GM
- Color: MV-CA023-10GC



## Specifications

Model	MV-CA023-10GM	MV-CA023-10GC
Parameters	2.3MP, 1/1.2" CMOS, GigE Camera	
<b>Camera</b>		
Sensor	IMX249	
Pixel Size	5.86μm×5.86μm	
Sensor Size	1/1.2"	
Resolution	1920×1200	
Frame Rate	41fps	
Dynamic Range	>70dB	
SNR	>40dB	
Gain Range	0-20dB	
Exposure Time	40μs-10sec	
Shutter Mode	Global Shutter. Auto-Exposure, Manual Exposure, One-key Exposure	
Data Interface	Gigabit Ethernet	
General Purpose I/O	Opto-isolated input x1, Opto-isolated output x1, Bi-directional non-isolated I/O x1	
Image Buffer	128MB	
Data Format	Mono 8/10/10p/12/12p	Mono 8/10/12, RGB8, Bayer RG 8/10/10p/12/12p, YUV 422 Packed, YUV422_YUYV_Packed
<b>General</b>		
Power	< 3W@12VDC, Voltage 5~15VDC, PoE supported	
Temperature	Working Temperature 0~50°C, Storage Temperature -30~70°C	
Humidity	20%-80% RH without condensation	
Dimension	29mm×29mm×42mm	
Weight	< 68g	
Lens Interface	C-Mount	
Software	MVS or Third-Party Software supporting GigE Vision Protocol	
Operating System	Windows XP/7/10 32/64bits	
Compliance	GigE Vision	
Certification	CE, FCC, RoHS	

### Dimensions

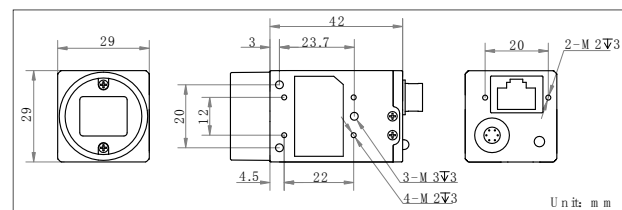

### Recommended Accessories

- **Power:** 12VDC @1A power adapter
- **NIC:** Intel Pro1000 and above version recommended
- **Network Cable:** CAT5e or CAT6 network cable recommended



Germany, Austria, Switzerland  
**Sedeco Imaging GmbH**  
 Unterer Dammweg 12  
 76149 Karlsruhe  
 Germany  
 T. +49 721 5604 7980  
 info@sedeco-imaging.com

BeNeLux  
**Sedeco Imaging B.V.**  
 Trasmolenlaan 12  
 3447 GZ Woerden  
 the Netherlands  
 T. +31 348 749110  
 info@sedeco-imaging.nl

[www.sedeco-imaging.com](http://www.sedeco-imaging.com)