

DC 48V voltage light control power supply **0-5v**

# 300W•600W high-capacity voltage light control power supply

## IWDV(SL)-48 series Analog

It's suitable high-capacity voltage light for line-sensor • large surface lighting  
Simple control • low cost power supply



- As it is capable of varying output voltage, the IWDV series is ideal for use with a line-sensor camera or high-speed camera.
- Available until 600W large size illumination of DC 48V.
- It's able to be simple control by stepless volume. External control is an analog 0-5V.

Model	IWDV-300SL-48	IWDV-600SL-48
Input Voltage	AC100~240V	
Operating Frequency	50/60Hz	
Rated Output	DC48V	
Capacity	300W	600W
Output Channel	1CH(2 connectors, 2 lighting connection ports per connector)	
Light Control Method	Variable output voltage system	
External Control	External ON/OFF External light control (Analog 0-5V)	

### Supported Lights



Large Flat-surface Light (White)  
IFD series (P.38)



Replacable from fluorescent light  
IDBA-RK series (P.15)

### Connection cable

Model	Length(m)
I-CB-S1-DN	1
I-CB-S2-DN	2
I-CB-S3-DN	3
I-CB-S5-DN	5
I-CB-S10-DN	10

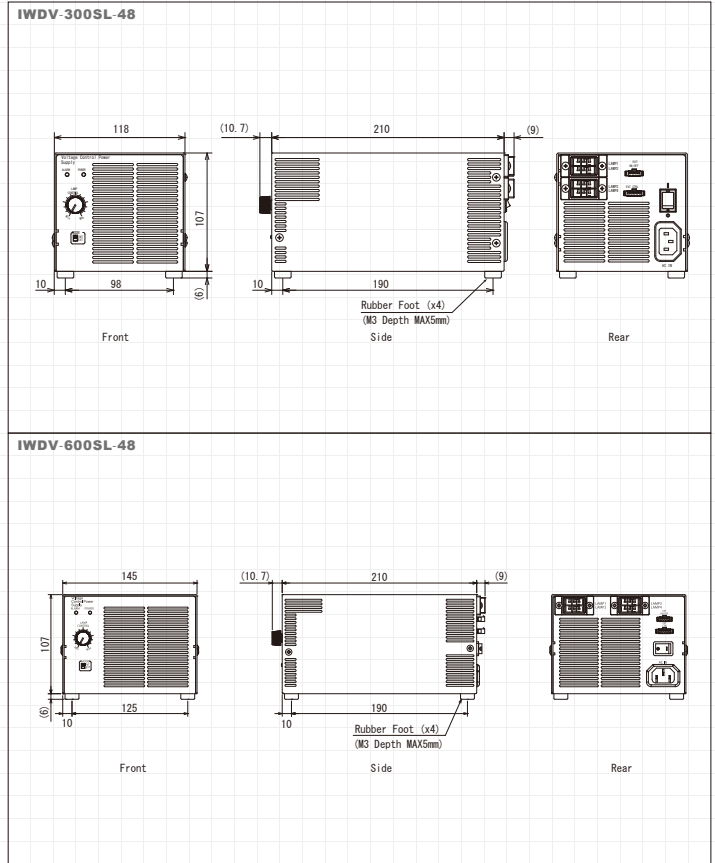

### Configuration example

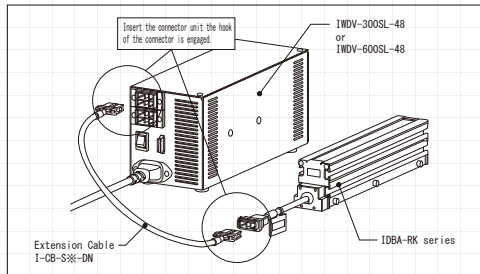

### External ON/OFF control cable.

Pin No.	Wire Color	Model	Length(m)
1	White	I-CB-D1	1
2	Green	I-CB-D2	2
3	Red	I-CB-D3	3
4	Black	I-CB-D4	4
		I-CB-D5	5
		I-CB-D10	10

\*Cables are also available in lengths other than those indicated above.  
\*SM connectors are made by JST.

### Analog 0-5V dimming control cable

Pin No.	Wire Color	Model	Length(m)
1	White	IC-TH-S1	1
2	Red	IC-TH-S2	2
3	Black	IC-TH-S3	3
4	N/A	IC-TH-S4	4
5	N/A	IC-TH-S5	5
		IC-TH-S10	10

\*Cables are also available in lengths other than those indicated above.  
\*SM connectors are made by JST.

### Output connector

By inputting analogue 0-5v signal in EXT CTRL connector on the back of the body, brightness of LED lights can be controlled by from 0% to 100%.

EXT CTRL connector specification	Connection example												
<table border="1"> <thead> <tr> <th>Pin No.</th> <th>Signal content</th> </tr> </thead> <tbody> <tr> <td>1</td> <td>+5V output</td> </tr> <tr> <td>2</td> <td>0-5V input</td> </tr> <tr> <td>3</td> <td>GND</td> </tr> <tr> <td>4</td> <td>NC</td> </tr> <tr> <td>5</td> <td>NC</td> </tr> </tbody> </table>	Pin No.	Signal content	1	+5V output	2	0-5V input	3	GND	4	NC	5	NC	<p>+5V</p> <p>0-5V input</p> <p>IWDV-300SL-48 side</p> <p>User side</p>
Pin No.	Signal content												
1	+5V output												
2	0-5V input												
3	GND												
4	NC												
5	NC												

INDEX  
Line Light  
Ring Light  
Bar Light  
Transmissive Light  
Dome Light  
Coaxial Light  
Special Lighting  
Power Supplies  
Optional Accessories